

APPROVED
MAR 18 2021
BOARD OF RECREATION
AND PARK COMMISSIONERS

BOARD REPORT

NO. 21-049

DATE March 18, 2021

C.D. 10

BOARD OF RECREATION AND PARK COMMISSIONERS

SUBJECT: QUEEN ANNE RECREATION CENTER – LIGHTING AND SECURITY CAMERAS (PRJ21339) PROJECT – COMMITMENT OF PARK FEES – CATEGORICAL EXEMPTION FROM THE PROVISIONS OF THE CALIFORNIA ENVIRONMENTAL QUALITY ACT (CEQA) PURSUANT TO ARTICLE III, SECTION 1, CLASS 1(1) [EXTERIOR ALTERATIONS INVOLVING MINOR CONSTRUCTION WHERE THERE BE NEGLIGIBLE OR NO EXPANSION OF USE], CLASS 1(12) [OUTDOOR LIGHTING FOR SECURITY AND OPERATIONS], CLASS 2 [REPLACEMENT OF EXISTING STRUCTURES WHERE THE NEW STRUCTURE WILL BE LOCATED ON THE SAME SITE AS THE STRUCTURE REPLACED AND WILL HAVE SUBSTANTIALLY THE SAME PURPOSE AND CAPACITY] AND CLASS 3(4) [INSTALLATION OF NEW EQUIPMENT INVOLVING NEGLIGIBLE OR NO EXPANSION OF USE IF REQUIRED FOR SAFETY AND THE PUBLIC CONVENIENCE] OF CITY CEQA GUIDELINES AND TO ARTICLE 19, SECTIONS 15301, 15302 AND 15303 OF CALIFORNIA CEQA GUIDELINES

AP Diaz	_____	M. Rudnick	_____
H. Fujita	_____	<i>for</i> C. Santo Domingo	<u>DF</u>
V. Israel	_____	N. Williams	_____



General Manager

Approved X Disapproved _____ Withdrawn _____

RECOMMENDATIONS

1. Approve the scope of work for the Queen Anne Recreation Center – Lighting and Security Cameras (PRJ21339) Project (Project), as described in the Summary of this Report;
2. Approve the Project to be bid and constructed through the Department of Recreation and Parks (RAP) list of pre-qualified on-call contractors;
3. Approve the authorization of change orders as authorized under Report No. 06-136, for the construction contracts for this Project in the budget contingency amounts for such contracts as stated in this Report;
4. Authorize RAP Staff to commit from the following fund and work order number, a maximum of Eight Hundred Fifty Thousand Dollars (\$850,000.00) in Park Fees, for the Queen Anne Recreation Center – Lighting and Security Cameras (PRJ21339) Project:

BOARD REPORT

PG. 2 NO. 21-049

<u>FUNDING SOURCE</u>	<u>FUND/DEPT./ACCT. NO.</u>	<u>WORK ORDER NO.</u>
Park Fees	302/89/89716H	QT073995

5. Determine that the proposed Project is categorically exempt from the provisions of the California Environmental Quality Act (CEQA) pursuant to Article III, Section 1, Class 1(1) [Exterior alterations involving minor construction where there be negligible or no expansion of use], Class 1(12) [Outdoor lighting for security and operations], Class 2 [Replacement of existing structures where the new structure will be located on the same site as the structure replaced and will have substantially the same purpose and capacity] and Class 3(4) [Installation of new equipment involving negligible or no expansion of use if required for safety and the public convenience] of City CEQA Guidelines and to Article 19, Sections 15301, 15302 and 15303 of California CEQA Guidelines and direct RAP Staff to file a Notice of Exemption (NOE) with the Los Angeles County Clerk;
6. Authorize RAP's Chief Accounting Employee or designee to prepare a check to the Los Angeles County Clerk in the amount of \$75.00 for the purpose of filing a Notice of Exemption (NOE); and,
7. Authorize RAP staff to make technical corrections as necessary to carry out the intent of this Report.

SUMMARY

Queen Anne Recreation Center is located at 1240 West Boulevard in the Mid-City community of the City. This 5.23-acre property includes ball diamonds, a play area, a splash pad, and recreation center. Approximately 6,642 City residents live within one-half mile walking distance of Queen Anne Recreation Center. Due to its facilities and features, and the programs and services provided on site, Queen Anne Recreation Center meets the standard for a Community Park, as defined in the City's Public Recreation Plan.

PROJECT SCOPE

RAP staff has identified a need to upgrade the existing park, sports court, and field lighting at Queen Anne Recreation Center, and to install new security cameras.

The proposed Queen Anne Recreation Center – Lighting and Security Cameras (PRJ21339) Project includes the following:

- The installation of a camera system and required conduit support system.
- The replacement of ten existing lighting fixtures with Light Emitting Diode (LED) light fixtures.
- The upgrade of parking lot lighting to RAP standards, which requires the demolition of one existing lightweight pole and the addition of two new poles. The overhead line will be removed and the conduit will be placed underground.

BOARD REPORT

PG. 3 NO. 21-049

- The upgrade of tennis court lighting to RAP standards, which requires the changing of light fixtures on existing poles.
- The upgrade of basketball lighting to RAP standards, which requires the replacement of one pole and the changing of existing light fixtures.
- The upgrade of baseball field lighting to RAP standards, which requires the replacement of the infield poles and changing of light fixtures on outfield poles.
- The installation of new bleachers.

The proposed Project will be constructed utilizing RAP's pre-qualified on call contractors and/or vendors currently under contract with RAP.

PROJECT FUNDING

Upon approval of this Report, Eight Hundred Fifty Thousand Dollars (\$850,000.00) in Park Fees can be committed to the proposed Project.

These Park Fees were collected within five (5) miles of Queen Anne Recreation Center, which is the standard distance for the commitment of the Park Fees for community recreational facilities pursuant to Los Angeles Municipal Code Section 12.33 E.3.

The anticipated pre-qualified on-call contracts will be for Electrical Construction and Retrofit. The budget contingency for the Electrical Construction and Retrofit contracts will be Eighty Five Thousand Dollars (\$85,000).

FUNDING SOURCE MATRIX

Source	Fund/Dept/Acct	Amount	Percentage
Park Fees	302/89/89716H	\$850,000.00	100%
Total		\$850,000.00	100%

PROJECT CONSTRUCTION

RAP Staff has determined that sufficient funding has been identified and construction of the proposed Project is anticipated to begin in Summer 2021.

TREES AND SHADE

This proposed Project will have no impact on the existing trees and shade at Queen Anne Recreation Center.

BOARD REPORT

PG. 4 NO. 21-049

ENVIRONMENTAL IMPACT

The proposed Project consists of exterior alterations involving minor construction where there be negligible or no expansion of use; outdoor lighting for security and operations; replacement of existing structures where the new structure will be located on the same site as the structure replaced and will have substantially the same purpose and capacity and of installation of new equipment involving negligible or no expansion of use if required for safety and the public convenience. As such, RAP Staff recommends that the Board of Recreation and Park Commissioners (Board) determines that it is categorically exempt from the provisions of the California Environmental Quality Act (CEQA) pursuant to Article III, Section 1, Class 1(1), Class 1(12), Class 2 and Class 3(4) of City CEQA Guidelines and Article 19, Section 15301, 15302 and 15303 of California CEQA Guidelines. RAP Staff will file an NOE with the Los Angeles County Clerk upon the Board's approval.

FISCAL IMPACT

The approval of this commitment of Park Fees will have no fiscal impact on RAP's General Fund. The estimated costs for the design, development, and construction of the proposed park improvements are anticipated to be funded by Park Fees or funding sources other than the RAP's General Fund. The maintenance of the proposed park improvements can be performed by current staff with minimal impact to existing maintenance service at this facility.

STRATEGIC PLAN INITIATIVES AND GOALS

Approval of this Board Report advances RAP's Strategic Plan by supporting:

Goal No. 1: Provide Safe and Accessible Parks

Outcome No. 2: All parks are safe and welcoming

Result: The upgrade to existing lighting and installation of security cameras will increase safety and enhance the park users' experience.

This Report was prepared by Ligaya Khennavong, Management Assistant, Planning, Maintenance and Construction Branch.

LIST OF ATTACHMENTS

- 1) Project Plans



12th St

Mullen Ave

Murrell Road

West Blvd

Greenway Pl

Fico Blvd

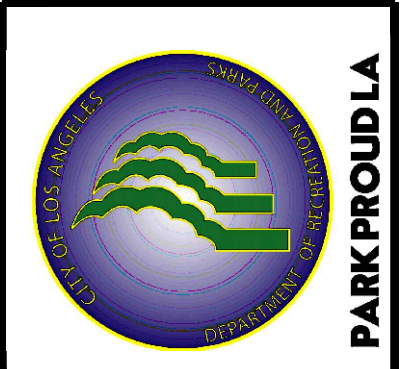

THE CITY OF LOS ANGELES
 DEPARTMENT OF RECREATION AND PARKS
 ASSISTANT MANAGER: RAMON BARAJAS
 GENERAL MANAGER: MICHAEL A. SHULL
 PROJECT LANDSCAPE ARCHITECT: David Choi
 PROJECT ENGINEER: David Choi
 LIC. NO. _____ E: 18742
 LIC. NO. _____ E: 18742
 DATE: _____
 AS-BUILT DRAWN BY: _____

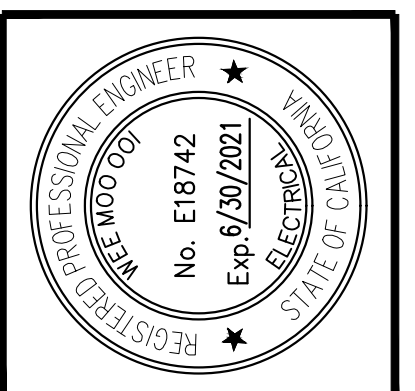

PROJECT NAME:
**QUEEN ANN PARK LTG
 UPGRADE & CCTV INSTL.**
 ADDRESS:
**1240 WEST BLVD
 LOS ANGELES, CA 90019**

REVISIONS:	DATE:

PLAN NAME:
 DEMOLITION PLAN

DRAWN BY: DO	APPROVED BY:
SCALE: 5/16/2020	ISSUE DATE:
W.O. NO.	FILE NO.

DRAWING NO.
E3.0
 SHEET 3 OF 8 SHEETS

SHEET NOTES

1. THE ELECTRICAL CONTRACTOR SHALL DEMOLISH THE EXISTING BALL FIELD, TENNIS COURT, BASKETBALL COURT, PARKING LOT, ETC LIGHTING SYSTEM AS IDENTIFIED. THE ELECTRICAL CONTRACTOR SHALL DEACTIVATE, DISCONNECT AND REMOVE THE LIGHTING SYSTEM WHICH WILL BE DEMOLISHED. UNLESS OTHERWISE NOTED, THE ELECTRICAL CONTRACTOR SHALL REMOVE AND DISPOSE OF ALL ELECTRICAL SYSTEM MATERIALS INCLUDING FIXTURE, UG CONDUITS, CABLE AND ETC.
2. PRIOR TO REMOVAL OF EQUIPMENT, CONTACT RAP ELECTRICAL SHOP FOR ITEMS SALVAGEABLE.

SYMBOL LEGEND

- EXISTING LUMINAIRE
- EXISTING POLE
- EXISTING SWITCHBOARD
- P# POLE NUMBER

KEY NOTES

1. UNLESS OTHERWISE SPECIFIED, REMOVE EXISTING LUMINAIRE PER REMOVAL SCHEDULE. PROTECT EXISTING WIRING, CONDUIT, POLE AND FOUNDATION IN PLACE.
2. DISCONNECT AND REMOVE THE EXISTING PANEL "B" AND THE ENCLOSURE "E", AND THE CONTACTORS. PROTECT EXISTING STUBUPS AND CONDUCTORS, AND THE HOMERUNS (BASEBALL LTG, SECURITY LTG & BASKETBALL LTG).
3. REMOVE THE EXISTING LUMINAIRE, POLE AND FOUNDATION. REMOVE EXISTING WIRES, CUT CONDUITS 18" BELOW GRADE.
4. REMOVE THE EXISTING LUMINAIRE, POLE AND FOUNDATION. PROTECT EXISTING WIRE AND CONDUIT.
5. DISCONNECT AND REMOVE THE EXISTING OVERHEAD CABLES.
6. DISCONNECT AND REMOVE THE EXISTING 400A SWITCHBOARD. PROTECT EXISTING STUBUPS AND CONDUCTORS, AND THE EXISTING HOMERUNS (TENNIS COURT LIGHTING). COORDINATE ANY ELECTRICAL SHUTDOWNS WITH LADWP.

REMOVAL SCHEDULE					
POLES		LUMINAIRES			REMARKS
POLE ID	HEIGHT	QTY	HID WATTS PER FIXT	TOTAL WATTS PER POLE	
P1	30'	1	440	440	TENNIS
P2	30'	2	440	880	TENNIS
P3	30'	2	440	880	TENNIS
P4	30'	2	440	880	TENNIS
P5	30'	1	440	440	TENNIS
P6	30'	2	440	880	TENNIS
P7	30'	2	440	880	TENNIS
P8	30'	1	440	880	TENNIS
P9	30'	2	440	880	TENNIS
P10	30'	2	440	880	TENNIS
P11	30'	2	440	880	TENNIS
P12	30'	1	440	440	TENNIS
P13	60'	6	1100	6600	BASEBALL
P14	49'	4	1100	4400	BASEBALL
P15	60'	6	1100	6600	BASEBALL
P16	49'	4	1100	4400	BASEBALL
P17	49'	4	1100	4400	BASEBALL
P18	49'	4	1100	4400	BASEBALL
P19	30'	2	440	880	DRIVEWAY
P20	30'	1	440	440	BASKETBALL
P21	30'	1	440	440	BASKETBALL
P22	30'	1	440	440	BASKETBALL
P23	30'	1	440	440	BASKETBALL
P24	30'	2	440	880	AREA/SECURITY
P25	30'	2	440	880	PARKING LOT
P26	30'	2	440	880	PARKING LOT
P27	49'	2	1100	2200	BASEBALL
TOTAL:		62		47520	

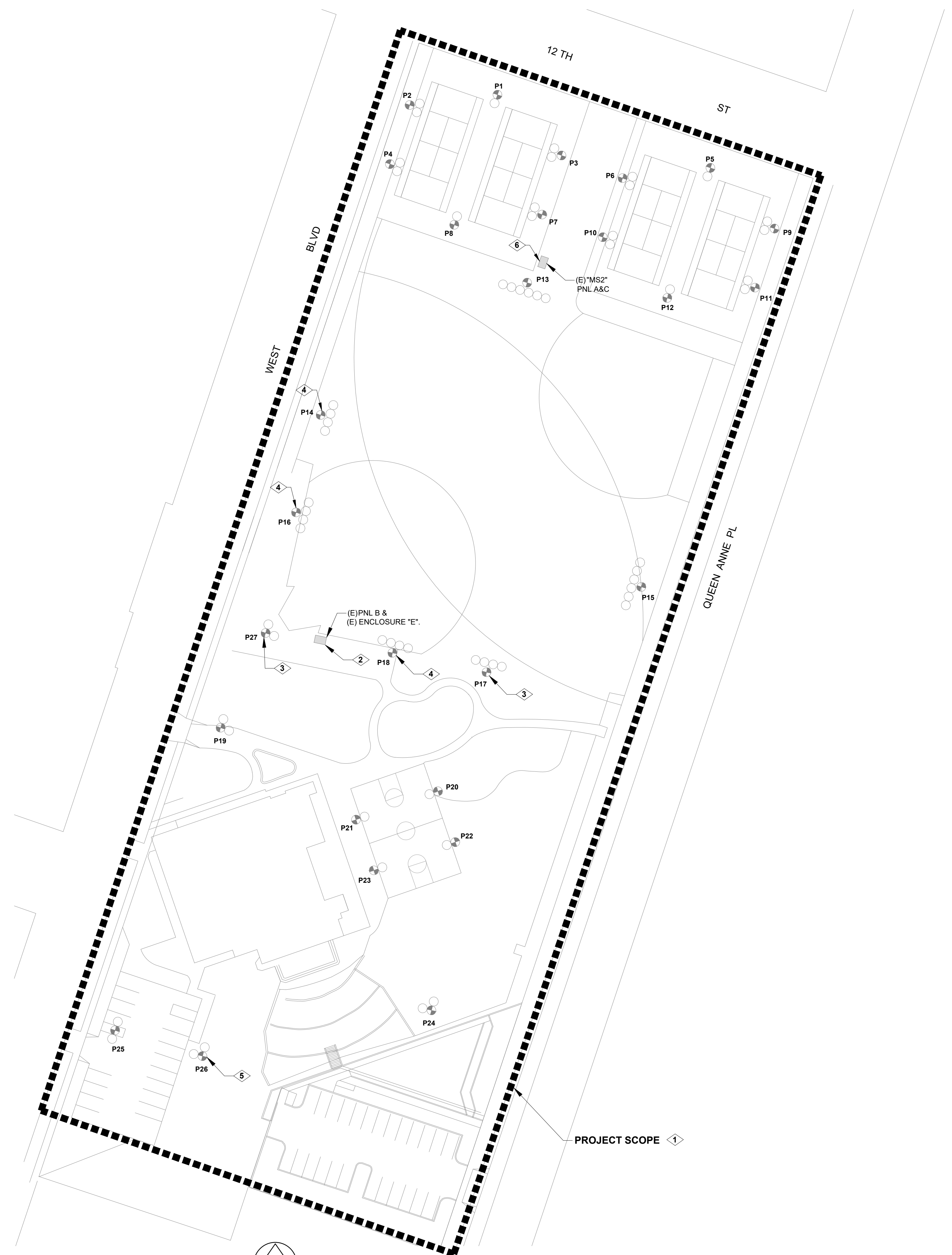

DEMO PLAN
 SCALE: 1 : 40

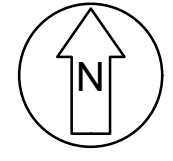

UNLESS OTHERWISE AUTHORIZED BY THE DEPT OF RECREATION AND PARKS, CITY OF LOS ANGELES, ALL WORK OR ANY SUBSTANTIALLY IDENTICAL WORK CONTAINED HEREIN SHALL NOT BE DUPLICATED OR REPRODUCED.

FIXTURE SCHEDULE											
SYMBOL	QTY	CAT #	DESCRIPTION	LAMP	IES FILE	MTG	LUMENS	LLF	WATTS	VOLTS	CURRENTS
A	24	VUE-4-T4-208L-1-50K-UNV-7PIN	POWER OFF AT 10:30 PM PREPROGRAMMED	LED	VUE-4-T4-208L-1-50K	POLE	71496	1.0	662	120-277V	1050 mA
B	60	VUE-4-T4-224L-1-50K-UNV-7PIN	POWER OFF AT 10:30 PM PREPROGRAMMED	LED	VUE-4-T4-224L-1-50K	POLE	76788	1.0	711	120-277V	1050 mA
C	4	VUE-1-T5-64L-700-50K-UNV-7PIN	POWER OFF AT 10:30 PM PREPROGRAMMED	LED	VUE-1-T5-64L-700-50K	POLE	15096	1.0	136	120-277V	1050 mA
D	3	VUE-1-T2-64L-700-50K-UNV-7PIN	POWER OFF AT 10:30 PM PREPROGRAMMED	LED	VUE-1-T2-64L-700-50K	POLE	21320	1.0	205	120-277V	1050 mA

INSTALLATION SCHEDULE						REMARKS
POLES		LUMINAIRES				
POLE ID	HEIGHT	QTY	LED WATTS PER FIXT	TOTAL WATTS PER POLE		
P1	30'	1	662	662	TENNIS	
P2	30'	2	662	1324	TENNIS	
P3	30'	2	662	1324	TENNIS	
P4	30'	2	662	1324	TENNIS	
P5	30'	1	662	662	TENNIS	
P6	30'	2	662	1324	TENNIS	
P7	30'	2	662	1324	TENNIS	
P8	30'	1	662	662	TENNIS	
P9	30'	2	662	1324	TENNIS	
P10	30'	2	662	1324	TENNIS	
P11	30'	2	662	1324	TENNIS	
P12	30'	1	662	662	TENNIS	
P13	60' 55'	5	711	3555	BASEBALL BASEBALL	
P14	60' 55'	5	711	3555	BASEBALL BASEBALL	
P15	60' 55'	5	711	3555	BASEBALL BASEBALL	
P16	60' 55'	5	711	3555	BASEBALL BASEBALL	
P17	60' 55'	5	711	3555	BASEBALL BASEBALL	
P18	60' 55'	5	711	3555	BASEBALL BASEBALL	
P19	30'	2	136	272	DRIVEWAY	
P20	30'	1	662	662	BASKETBALL	
P21	30'	1	662	662	BASKETBALL	
P22	30'	1	662	662	BASKETBALL	
P23	30'	1	662	662	BASKETBALL	
P24	30'	2	136	272	AREA/SECURITY	
P25	30'	2	136	272	PARKING LOT	
P26	30'	1	136	272	PARKING LOT	
TOTAL:		91		54730		



SHEET NOTES

1. THE CONTRACTOR SHALL EXAMINE THE CONDITION OF THE EXISTING POWER CONNECTIONS, WIRING, AND JUNCTION BOXES AND REPORT ANY PROBLEMS TO THE PROJECT MANAGER.
2. THE CONTRACTOR SHALL DISCONNECT, REMOVE AND DISPOSE OF EXISTING FIXTURES IN ACCORDANCE WITH ACCEPTABLE PRACTICES AND REGULATIONS REGARDING SAME. PROVIDE COPIES TO DEPT. OF REC AND PARKS, OF ANY MANIFESTS REQUIRED DURING THE DISPOSAL OF ANY ENVIRONMENTALLY CONTROLLED SUBSTANCES.
3. THE CONTRACTOR SHALL PROVIDE AN ELECTRONIC COPY OF ALL FINAL DOCUMENTS INCLUDING OWNER'S MANUALS, SHOP DRAWINGS, WARRANTIES, INSPECTION REPORTS/CERTIFICATES, AND AS-BUILT DRAWINGS ON CD, DVD, OR FLASH MEMORY.

SYMBOL LEGEND

- TOP LED ASSEMBLY
- BOTTOM LED ASSEMBLY
- ⊕ EXISTING POLE
- ⊖ NEW POLE
- P# POLE NUMBER
- NEW SWITCHBOARD
- LED ARRANGEMENT: BACK-TO-BACK
- ⊕ LED ARRANGEMENT: TWIN
- ⊖ LED ARRANGEMENT: SINGLE WITH 2' ARM
- NEW PULL BOX

KEY NOTES

1. PROVIDE AND INSTALL LUMINAIRE PER INSTALLATION SCHEDULE.
2. PROVIDE AND INSTALL NEW 225A PANEL MATCHING THE EXISTING CHARACTERISTICS AND PROPERTY AT THE SAME LOCATION. SUBMIT SPECS FOR REVIEW AND APPROVAL.
3. PROVIDE AND INSTALL LUMINAIRE AND ENCLOSURE ASSEMBLY PER MANUFACTURER'S SPECIFICATIONS. SEE E6.0 FOR DETAILS.
4. TRENCH PER DETAIL 3.
5. PROVIDE AND INSTALL NEW UNDERGROUND FEEDER EXTENDS FROM P25.
6. INSTALL PULLBOX PER DETAIL 1 AND TACK WELD PULLBOX COVER.
7. PROVIDE AND INSTALL NEW POLE AND FOUNDATION PER MANUFACTURER'S SPECIFICATIONS AND STRUCTURAL ENGINEER'S DRAWINGS. CONTRACTOR SHALL OBTAIN GEOTECHNICAL ENGINEERING SERVICES TO INVESTIGATE THE SOILS CONDITIONS FOR THE NEW FOUNDATION AND THE STANDARD PLAN INCLUDING ONSITE SOILS INSPECTIONS AND OBSERVATIONS.
8. INSTALL INLINE CROSS ARM PER DETAIL 2. SEE SYMBOL FOR FIXTURE ARRANGEMENT.
9. PROVIDE AND INSTALL NEW 400A METERED SWITCHBOARD COMPLETE WITH INSTRUMENT COMPARTMENT AND MATCHING EXISTING PROPERTY AND RATINGS. SEE E8.0 FOR SWITCHBOARD DETAILS. PROVIDE AND INSTALL NEW CONTACTORS MATCHING EXISTING ELECTRICAL RATINGS AND PROPERTY.

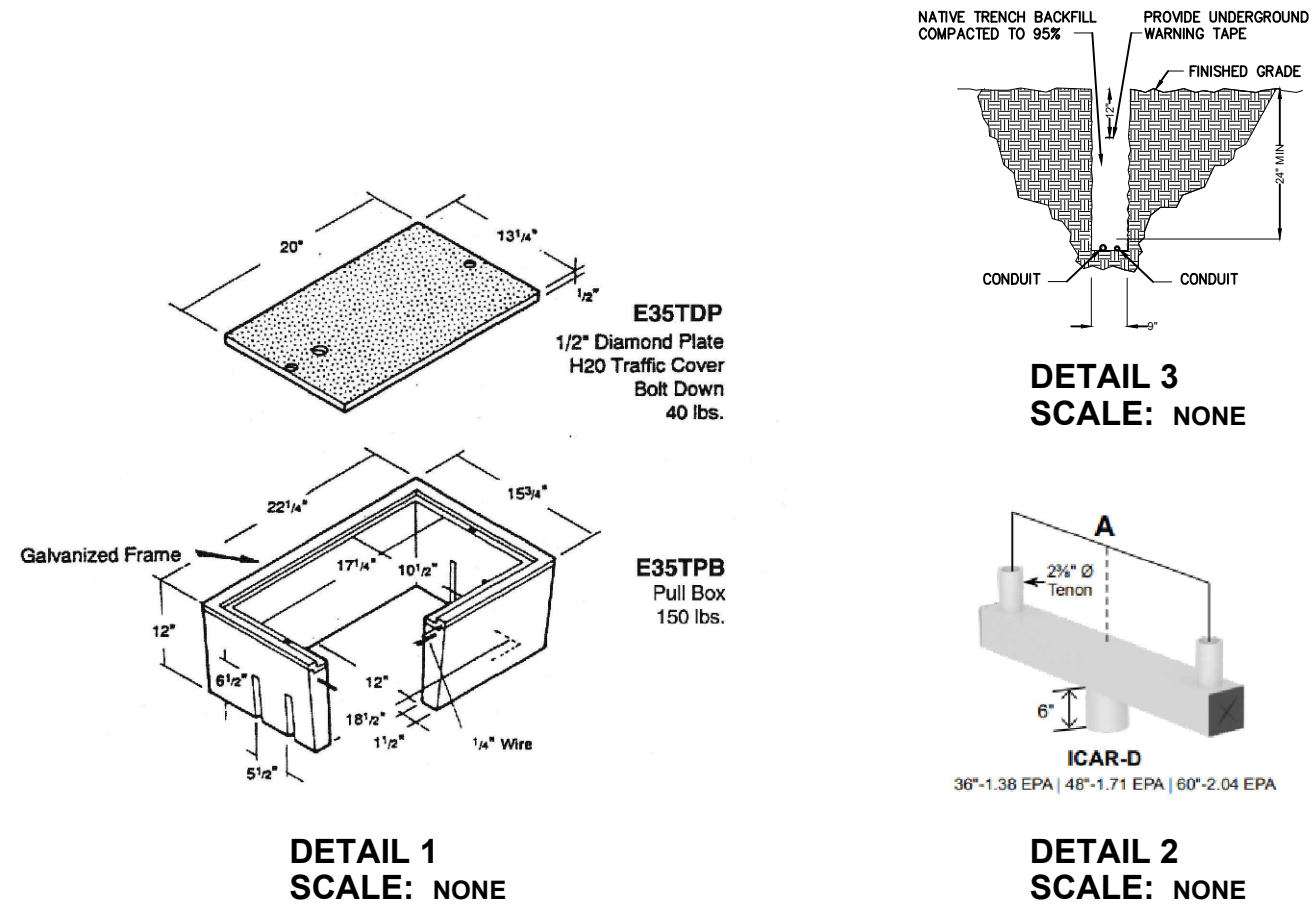

ELECTRICAL SITE PLAN SCALE: 1 : 40

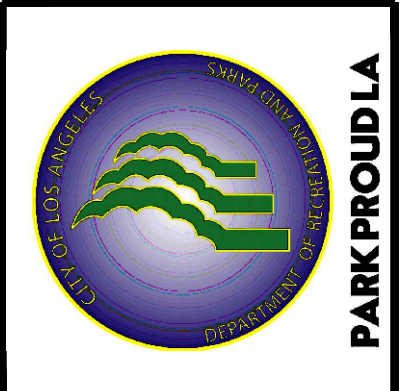

THE CITY OF LOS ANGELES
DEPARTMENT OF RECREATION AND PARKS
ASSISTANT MANAGER: RAMON BARAJAS
GENERAL MANAGER: MICHAEL A. SHULL
PROJECT LANDSCAPE ARCHITECT: David Choi
PROJECT ENGINEER: David Choi
DATE: _____



PROJECT NAME:
QUEEN ANN PARK LTG UPGRADE & CCTV INSTL.
ADDRESS:
**1240 WEST BLVD
LOS ANGELES, CA 90019**

REVISIONS:	DATE:

PLAN NAME:
ELECTRICAL SITE PLAN

DRAWN BY: DO APPROVED BY: _____
SCALE: _____ ISSUE DATE: 5/16/2020
W.O. NO. _____ FILE NO. _____

DRAWING NO.
E4.0
SHEET 4 OF 8 SHEETS

UNLESS OTHERWISE AUTHORIZED BY THE DEPT OF RECREATION AND PARKS, CITY OF LOS ANGELES, ALL WORK OR ANY SUBSTANTIALLY IDENTICAL WORK CONTAINED HEREIN SHALL NOT BE DUPLICATED OR REPRODUCED.