

FOR INFORMATION ONLY

CITY OF LOS ANGELES
DEPARTMENT OF RECREATION AND PARKS

July 13, 2011

TO: BOARD OF RECREATION AND PARK COMMISSIONERS
FROM: JON KIRK MURKI, General Manager 
SUBJECT: STATUS OF ECHO PARK LAKE REHABILITATION PROJECT

Background

The Echo Park - Lake Rehabilitation Project (Project) (W.O. #EW40020A) is located within Echo Park at 751 Echo Park Avenue. The scope of the project entails the construction of various improvements in and around Echo Park Lake (Lake) including vegetation, habitat and park improvements and the implementation of parkland structural best management practices (BMPs).

On March 23, 2011, in Board Report No. 11-091, the Board of Recreation and Park Commissioners (Board) approved the scope of the Project, as described in the project's Final Environmental Impact Report (FEIR); reviewed and considered the Project's FEIR and associated Technical Appendices and concurred with Project's certification by the City Council on December 7, 2010; concurred with the Project's California Environmental Quality Act (CEQA) Findings and Statement of Overriding Considerations adopted by City Council on December 7, 2010 and made an additional finding that the alternatives to the proposed Project were infeasible; and, concurred with the Project's Mitigation Monitoring Program (MMP) that was adopted by City Council on December 7, 2010.

Echo Park - Lake Rehabilitation Project

In November 2004, the citizens of Los Angeles passed a \$500,000,000 Clean Water Bond Measure titled "Proposition O". The primary objective of all Proposition O funded projects is to protect public health by cleaning up pollution in the City's watercourses, beaches, and the ocean. The Lake has been identified by the State of California as an impaired water body with the following types of water quality issues: algae, ammonia, eutrophic conditions, copper, lead, odor, polychlorinated biphenyls, trash, and pH.

The broad goals of the Project are to improve the water quality conditions in the Lake and contribute to water quality improvements in the Los Angeles River Watershed, reduce use of municipal potable water, comply with the Regional Water Quality Control Board's intent to restore the Lake's existing and potential beneficial uses, help meet Total Maximum Daily Load requirements passed by the Regional Water Quality Control Board and other water quality targets, and implement multi-purpose solutions at the Lake that are consistent with the objectives of Proposition O.

The specific scope elements of the Project include the construction of a new Lake liner, approximately 4.2 acres of wetland vegetation, lotus bed restoration, a submerged partition berm to comply with California Department of Water Resources Division of Safety of Dams (DSOD) standards, a new Lake outlet structure, pump house demolition and construction of a new pump house near the southeastern shore of the Lake, new Lake water recirculation and aeration systems, low-flow runoff diversion into the Lake with the goal of reducing the use of municipal potable water, and extension of a storm drain to convey flood waters away from the site during construction. Additional BMPs include hydrodynamic separators, rain gardens, and irrigation system upgrades. Other improvements to the park include new overlook and boardwalk areas, new lighting, replacement of the path around the perimeter of the Lake, site furnishings, interpretative signage, and relocation of the Lady of the Lake statue to its original location.

The conceptual landscape plan for the Project is attached as Exhibit A.

The Project has a project budget of approximately \$84,863,313. The project will be funded with \$84,263,313 in Proposition O funds and approximately \$600,000 in Proposition K funds.

Current Status

On June 17, 2011 the Board of Public Works awarded a contract to Ford E.C., Inc. for the Project in the amount of \$24,485,000. Project construction is scheduled to begin during the week of July 11, 2011 and be completed by March 2013.

The first field meeting between staff from the Department of Recreation and Parks (Department), Department of Public Works, and the Project contractor was held on June 29, 2011. Staff representing the Department's Planning, Construction, and Maintenance Division and Operations Division were in attendance at the meeting to discuss various pre-construction and construction related issues. Once construction begins, it is anticipated that similar field meetings between City staff and the contractor will be held on a weekly basis.

This report was prepared by Darryl Ford, Management Analyst II, Planning, Construction and Maintenance Division.

ECHO PARK LAKE REHABILITATION CONCEPTUAL LANDSCAPE PLAN PLANO CONCEPTUAL DE DISEÑO DE PAISAJE

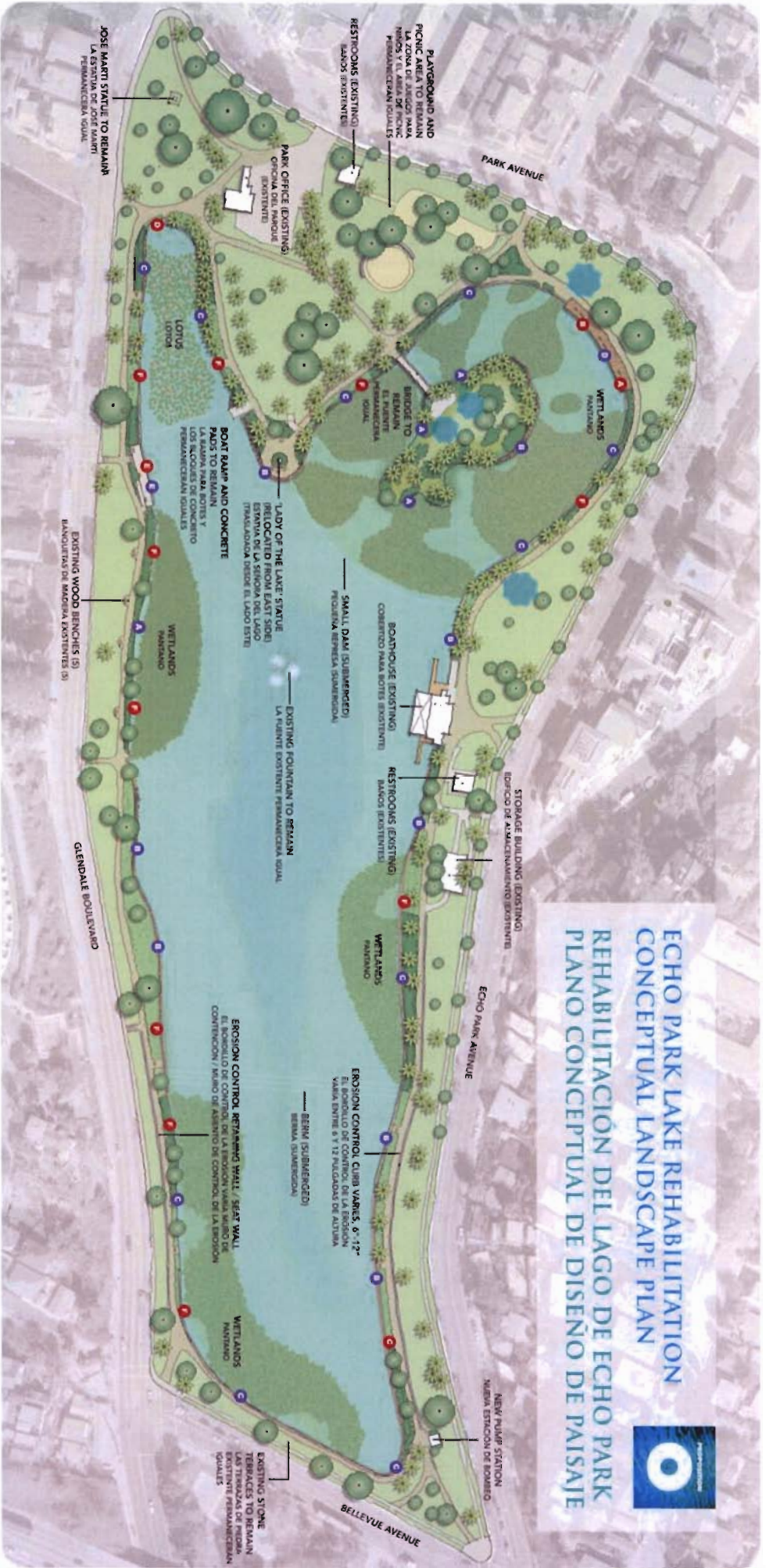

LEGEND

Interpretive Signage	Lake Edge	Planting	Handscape / Other
<ul style="list-style-type: none"> A Wetland B Habitat C Sustainability D Lotus E History F Do Not Disturb G Habitat 	<ul style="list-style-type: none"> A Planted slope B Grouted rock C Vertical wall D Wood walkway E Concrete overlook (using existing structure) 	<ul style="list-style-type: none"> A Palm tree* B Canopy tree* C Shrubs / ornamental grasses D Lawn E Wetland vegetation F Lotus beds 	<ul style="list-style-type: none"> A Concrete / asphalt paving B Porous paving C Bench (mounted) D Low retaining wall - proposed E Existing landscaping to remain F Temporary pond

* Tree locations are representational

LEVENDA

Carteles Interpretativos	Borde del lago	Vegetación plantada	Elementos sólidos del paisaje / otros
<ul style="list-style-type: none"> A Pantano B Habitat C Sostenibilidad D Lotus E Historia F No alterar el habitat 	<ul style="list-style-type: none"> A Ladera con vegetación plantada B Rocas empilhadas C Muro vertical D Sando de madera E Vista de concreto (usando la estructura existente) 	<ul style="list-style-type: none"> A Palmera* B Arbol de sombra* C Arbustos / pastos ornamentales D Césped E Vegetación de pantano F Luchos de loto 	<ul style="list-style-type: none"> A Concreto / pavimento de adofo B Pavimento poroso C Banqueta (montada) D Muro de retención de baja altura - propuesta E El diseño de paisaje actual permanecerá igual F Temporary pond

* Las ubicaciones de los árboles son representativas



A Proposition O water quality improvement project by the City of Los Angeles Department of Public Works and Department of Recreation and Parks

Un proyecto de mejora de la calidad del agua que recibe fondos de la Proposición O realizado por el Departamento de Obras Públicas de la Ciudad de Los Angeles y el Departamento de Recreación y Parques