

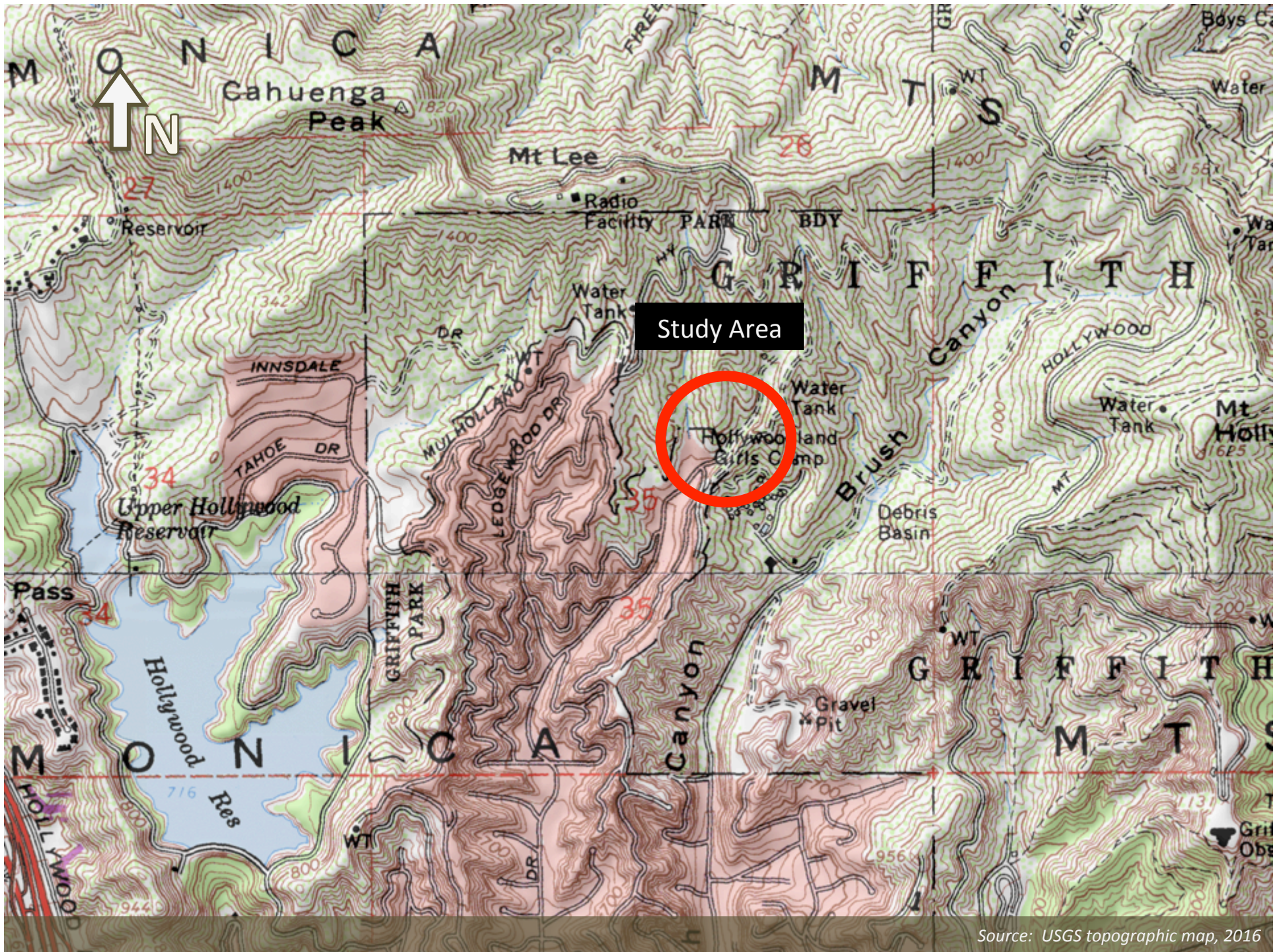

A topographic map of Griffith Park in Los Angeles, California. The map shows contour lines, major peaks like Cahuenga Peak (1820 ft) and Mt Lee (1400 ft), and features like the Upper Hollywood Reservoir and Griffith Canyon. A red line indicates a proposed trail route starting from Beachwood Drive, heading north through Griffith Canyon, and then east towards Griffith Park. The map also shows various landmarks like a Radio Facility, Water Tank, and Debris Basin.

Proposed Access to the Hollyridge Trail from Beachwood Drive

June 2017



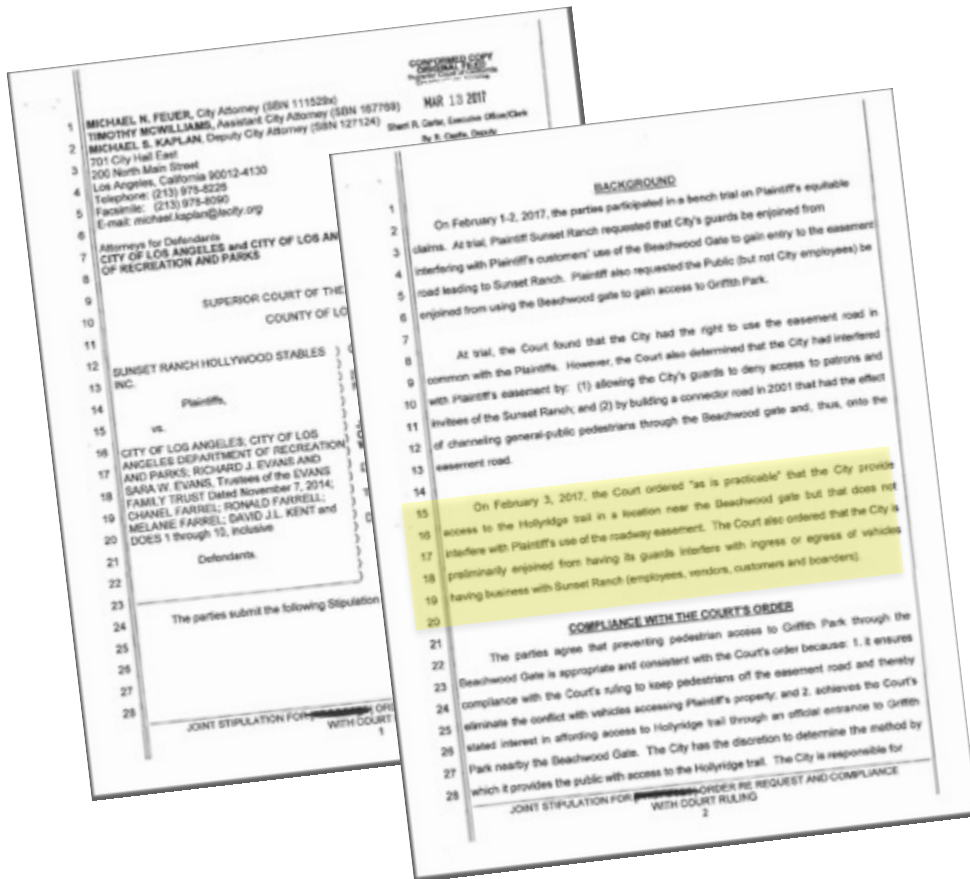

Court Order from Feb. 3rd, 2017 directing the City to provide access to the Hollyridge trail near the Beachwood gate

14
15 On February 3, 2017, the Court ordered "as is practicable" that the City provide
16 access to the Hollyridge trail in a location near the Beachwood gate but that does not
17 interfere with Plaintiff's use of the roadway easement. The Court also ordered that the City is
18 preliminarily enjoined from having its guards interfere with ingress or egress of vehicles
19 having business with Sunset Ranch (employees, vendors, customers and boarders).
20



Current location of taxpayer funded Gate for the private business, Sunset Ranch

Proposed general location of access point to Hollyridge Trail

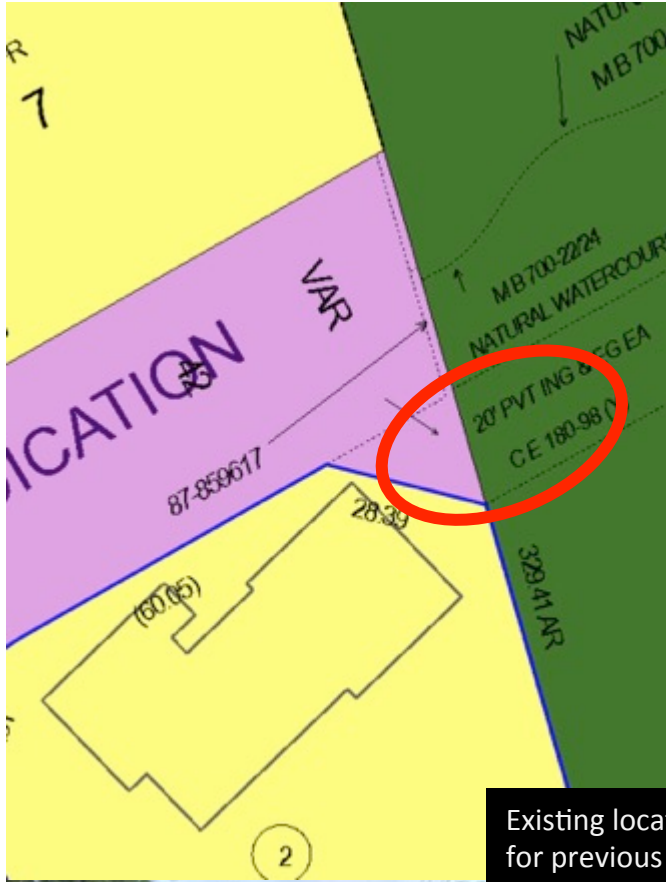

Existing location of gate for previous trail access

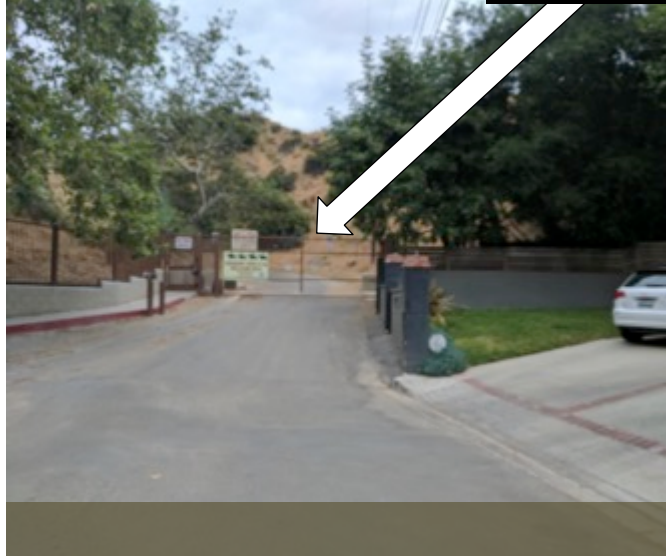

Proposed access to the Hollyridge Trail by transforming one of the three fence panels into a pedestrian gate.



Proposed access to Hollyridge Trail without utilizing the existing gate to Sunset Ranch

Current location of taxpayer funded Gate for the private business, Sunset Ranch

Source: from Los Angeles Zimas system and from Google Earth, imagery date 10/18/2016

Elevation difference from bottom to top of proposed Trail access, as estimated from USGS topographic maps and Google Earth data

Elevation: 941'

Elevation: 891'

Overall elevation change: 50'

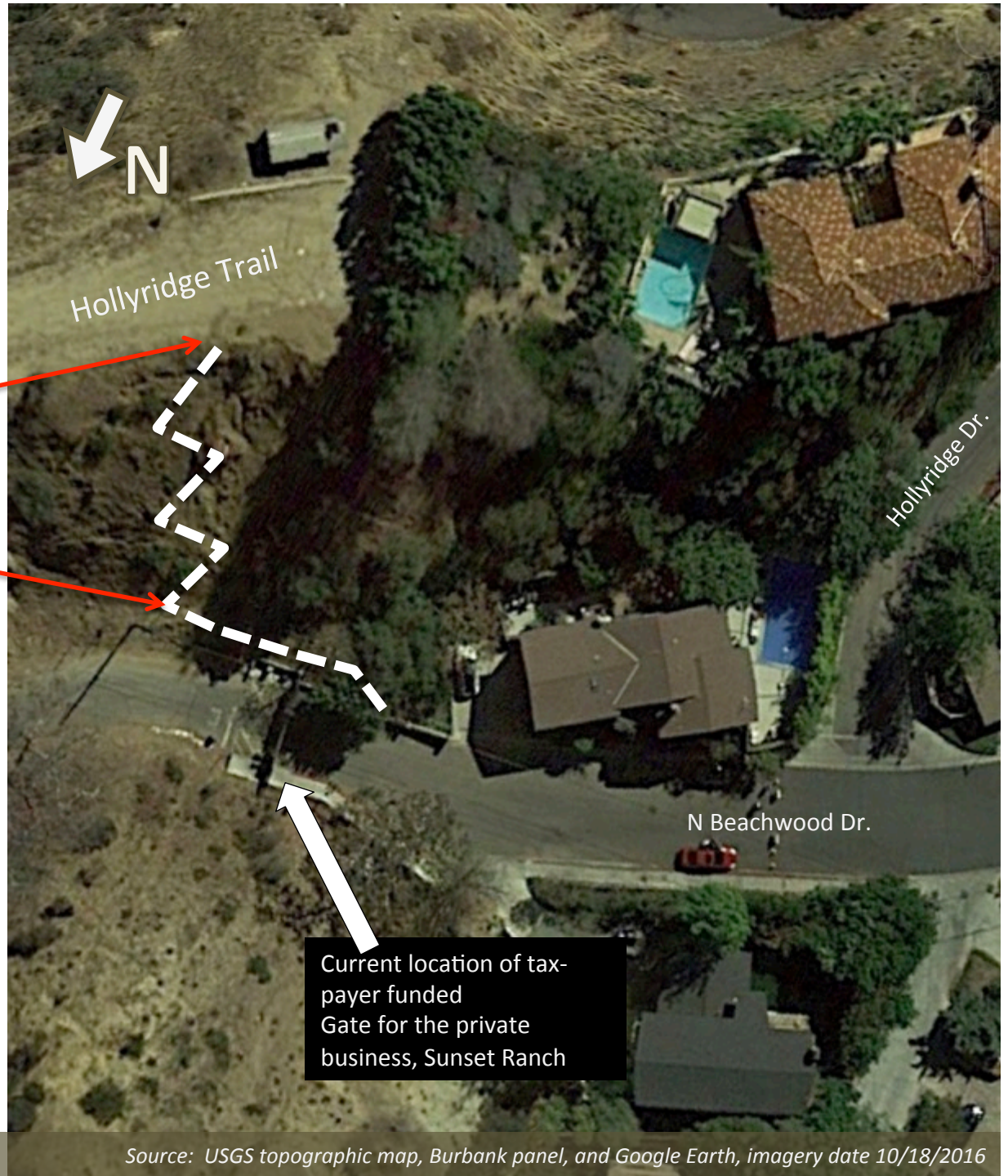

Source: USGS topographic map, Burbank panel, and Google Earth, imagery date 10/18/2016

Summary



Proposed access in front of the gate by removing a fence panel (within City/Griffith Park property)

